



ISHEN 2014

10th-13th SEPTEMBER

Venue:

De Vere Venues Sunningdale Park
LONDON



International Society for Hepatic Encephalopathy and Nitrogen Metabolism

WELCOME



It is with great pleasure I welcome you to the 16th ISHEN meeting in London. The understanding of the pathophysiological basis of hepatic encephalopathy has gained enormously from the very close interaction between basic scientists, translational biologists and clinicians. ISHEN, which was born over 40 years ago, has been at the forefront of creating an environment for these interactions. From a complication of cirrhosis which was thought to be mediated by alterations in nitrogen metabolism, the understanding the condition has progressed to involve multiple pathways including inflammation, alterations in brain neurochemistry and the involvement of many cell types in its pathogenesis. This understanding is rapidly evolving into new diagnostic and treatment paradigms. The 16th ISHEN meeting in London has been developed to explore these novel ideas in the understanding of hepatic encephalopathy keeping in mind how these advances may be relevant to the patient at present, in the near future and in the long-term. The first day is about what we know, days 2 and 3 is about new and exciting developments in the pathogenesis of hepatic encephalopathy and day 4 will focus more on the clinical aspects.

As with all successful scientific organisations, we have developed the programme keeping in mind the importance of discussion and engagement of young scientists and clinicians. In answer to our call, we are proud to announce that a record number of abstracts (nearly 90) will be presented at this meeting and we are offering about 51 full bursaries. As an organization, ISHEN is committed to its young members. For the first time, we have introduced workshops, which would allow closer and more focused discussions.

The 16th ISHEN meeting will celebrate the lives of two great scientists and clinicians, Professors Andy Blei and Professor Juan Cordoba who passed away prematurely in the past couple of years. Their contributions to ISHEN are enormous and their human values exemplary. The committee has decided to hold the 1st Andy Blei lecture, which will run in perpetuity. Professor Roger Butterworth, a long-standing friend of Andy's, has kindly agreed to deliver the lecture. A memorial will be held in the memory of Professor Cordoba. The young investigator prize will carry his name now and in the future.

I invite you to the meeting to participate, contribute, debate, share your knowledge, interact with the best scientists in the field and most of all have a fantastic time.

Rajiv Jalan
President, ISHEN



WEDNESDAY 10th SEPTEMBER 2014

Time	Details	Chair	Speaker	Room
12:30 - 13:20	Lunch			Steam Bake and Grill Restaurant
13:20 - 13:30	Introductory Welcome	Michael Arthur		
13:30 - 15:30	What we Know: Basic Science	Michael Arthur Roger Butterworth	13:40 - Roger Butterworth 14:00 - Rajiv Jalan 14:20 - Fin Larsen 14:40 - Dieter Haussinger YI Talks: 15:00 - Jordi Romero 15:15 - Yaldi Sharifi	Sharpe Suite
15:30 - 16:00	Refreshment Break			
16:00 - 17:30	What we Know: Clinical Science (part 1)	Kevin Mullen Hendrik Vilstrup	16:00 - Marsha Morgan 16:20 - Tarek Hassanein 16:40 - Gerald Kircheis YI Talks: 17:00 - Rune Gangsøy Kristiansen 17:15 - Carmina Montoliu	Sharpe Suite
17:30 - 17:45	Refreshment Break			
17:45 - 19:35	What we Know: Clinical Science (part 2)	Andrew Langford Roger Williams	17:45 - Javier Vaquero 18:05 - Will Bernal 18:25 - Jude Oben 18:45 - Oliviero Riggio YI Talks: 19:05 - Chantel Bémour 19:20 - Cristina Lucidi	Sharpe Suite

THURSDAY 11th SEPTEMBER 2014

Time	Details	Chair	Speaker	Room
08:30 - 10:00	Workshop 1: Basic Science: The Cellular Basis of HE	Freimut Schliess Marc Oria	YI Presenters	Sharpe Suite A
08:30 - 10:00	Workshop 2: Clinical Science: Targeting the gut/liver/brain Axis	Debbie Shawcross Jasmohan Bajaj	YI Presenters	Sharpe Suite B
10:00 - 10:30	Refreshment Break			
10:30 - 12:30	Inflammation in the Brain	Roger Butterworth Gavin Wright	10:30 - Vicente Arroyo 10:50 - Djillal Annane 11:10 - Mark Swain 11:30 - Faouzi Saliba YI Talks: 11:50 - Sharon DeMorrow 12:10 - Anne Witt	Sharpe Suite
12:30 - 13:30	Lunch Break			Steam Bake and Grill Restaurant
13:30 - 15:30	Development of Hepatic Encephalopathy	Sara Montagnase Micheal Sorenson	13:30 - Rita Garcia Martinez 13:50 - Richard Wise 14:10 - Dan Forton 14:30 - Susanne Keiding YI Talks: 14:50 - Markus Jördens 15:10 - Marc-André Clément	Sharpe Suite
15:30 - 16:00	Refreshment Break			
16:00 - 17:30	Ammonia: More than just a Neurotoxin	Peter Ott Chris Rose	16:00 - Srinivarsan Dasarathy 16:20 - Rajeshwar Mookerjee 16:40 - Alexander Thrane YI Talks: 17:00 - Balasubramaniyan Vairappan 17:15 - Veronika Rackayova	Sharpe Suite
17:30 - 17:45	Refreshment Break			
17:45 - 18:30	Andrés Blei Lecture	Rajiv Jalan	Roger Butterworth	Sharpe Suite
19:00 - 19:45	Football Match – Europe vs Rest of the World			
	Dinner and Entertainment			Steam Bake and Grill Restaurant



ISHEN 2014

FRIDAY 12th SEPTEMBER 2014

Time	Details	Chair	Speaker	Room
08:30 - 10:00	Workshop 3: Basic Science: Brain Swelling as an Endpoint	Chris Rose Arthur Cooper	YI Presenters	Sharpe Suite A
08:30 - 10:00	Workshop 4: Clinical Science: Quantifying & Qualifying MHE	Karin Weissenborn Marsha Morgan Gerald Kircheis Sara Montagnase Piero Amodio	YI Presenters	Sharpe Suite B
10:00 - 10:30	Refreshment Break			
10:30 - 12:30	The Microbiome in Liver Disease	Nathan Davies Alastair Forbes	10:30 - Jasmohan Bajaj 10:50 - Wim Laleman 11:10 - Julian Marchesi 11:30 - Agustin Albillos YI Talks: 11:50 - Ruben Francés 12:10 - Godhev Manakkat Vijay	Sharpe Suite
12:30 - 13:30	Lunch Break			
13:30 - 15:30	New Technologies - New Insights	Simon Taylor-Robinson Nicolaas Deutz	13:30 - Javier Ampuero Herrojo 13:50 - Nicolaas Deutz 14:10 - Elaine Holmes 14:30 - Boris Görg YI Talks: 14:50 - Bernard Lanz 15:10 - Fausto Andreola	Sharpe Suite
15:30 - 16:00	Refreshment Break			
16:00 - 17:50	Signalling and the Blood Brain Barrier	Jan Albrecht Scott Nyberg	16:00 - Peter Se arson 16:25 - AR Jayakumar 16:50 - Vicente Felipe YI Talks: 17:20 - Matthew McMillin 17:35 - Laia Chavarria	Sharpe Suite
17:50 - 18:00	Refreshment Break			
18:00 - 18:30	In Memory of Prof. Juan Cordoba			Sharpe Suite
19:30 - 00:30	Medieval Gala Dinner and Prizes			Northcote House

SATURDAY 13th SEPTEMBER 2014

Time	Details	Chair	Speaker	Room
08:00 - 10:15	Where are we going? i. Translational Research Panel Discussion and Questions	Marsha Morgan Piero Amodio	08:00 - Kevin Mullen 08:20 - Hendrik Vilstrup 08:40 - James Orr 09:00 - Sara Montegnase 09:20 - Alistair Lee	Sharpe Suite
10:15 - 10:45	Refreshment Break			
10:45 - 12:45	Where are we going? ii. Emerging Therapies Panel Discussion and Questions	Radha Dhiman Rajiv Jalan	10:45 - Scott Nyberg 11:05 - Barjesh Sharma 11:25 - Rajiv Jalan 11:45 - Don Rockey 12:05 - Manuela Merli	Sharpe Suite
12:45 - 13:30	General Membership Meeting & Final Remarks from Current and Future ISHEN Presidents			Sharpe Suite
13:30	Lunch & Departures			Steam Bake and Grill Restaurant

ENDORSEMENTS

ISHEN 2014 has received endorsements from the following affiliated organisations.



AMERICAN ASSOCIATION FOR
THE STUDY OF LIVER DISEASES



OUR SUPPORTERS



Abbott's Established Pharmaceuticals Division (EPD), headquartered in Basel, Switzerland, is focused on helping make the world a healthier place by bringing the benefits of trusted pharmaceutical brands to much broader patient populations - in the developed world and, particularly, in emerging markets. EPD brings value to its patients and customers through deep localization and a growing portfolio of high-quality established pharmaceutical products.

Abbott is a global healthcare company devoted to improving life through the development of products and technologies that span the breadth of healthcare. With a portfolio of leading, science-based offerings in diagnostics, medical devices, nutritionals and branded generic pharmaceuticals, Abbott serves people in more than 150 countries and employs approximately 70,000 people.

For more information www.abbott.co.uk

ALFA WASSERMANN

Alfa Wassermann was founded in 1948 in Bologna (Italy). It has grown abroad via the establishment of a network of distributors and the setting up of subsidiaries in 14 countries in Europe and some key non-European markets. Alfa Wassermann employs 1,420 people.

By believing and investing in research and development, Alfa Wassermann has been able to generate more than 60% of its turnover from original products, manufactured in its GMP-certified production plant. Our major achievement is Rifaximin- α (Normix®, Xifaxan® and others), an innovative intestine-targeted, non-absorbable antibiotic, now available in most countries worldwide, including the USA.

For more information www.alfawassermann.com



Gambro is a global medical technology company and a leader in developing, manufacturing and supplying products and therapies for Kidney and Liver dialysis, Myeloma Kidney Therapy, and other extracorporeal therapies for Chronic and Acute patients. For decades, Gambro has been first to market with many groundbreaking innovations. By designing and delivering solutions to dialysis clinics and intensive care units, Gambro offers not just improved treatment quality, but also improved efficiency. Gambro was founded in 1964 and has today 8 000 employees, 13 production facilities in 9 countries, and sales in more than 90 countries. Gambro AB (including all direct and indirect subsidiaries) is now part of Baxter International Inc.

For more information www.gambro.com



HYPERION THERAPEUTICS

Hyperion Therapeutics, Inc. is a commercial-stage biopharmaceutical company committed to advancing science and developing treatments for orphan and hepatic diseases.

For more information - www.hyperiontx.com

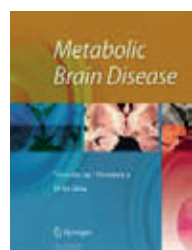

Metabolic Brain Disease serves as a forum for the publication of outstanding basic and clinical papers on all metabolic brain disease, including both human and animal studies. The journal publishes papers on the fundamental pathogenesis of these disorders and on related experimental and clinical techniques and methodologies. Metabolic Brain Disease is directed to neuroscientists, psychiatrists, neurologists, pathologists, and others involved in the research and treatment of a broad range of metabolic brain disorders.

For more information - link.springer.com/journal/11011



Merz Pharma is an innovative and international healthcare company with its own research and development department. The company is bundling the activities of its subsidiaries Merz Pharmaceuticals, Merz Consumer Care, and Merz Dental, with products ranging from prescription drugs and OTC products for health and wellness, materials for dentists and dental technicians to hygienic products for medical disinfection and cleaning.

For more information - www.merz.com



Founded in 1906, Norgine is an independent pan-European specialty pharmaceutical company. Throughout our long history, we have sought to develop and market high quality and innovative products that patients, healthcare professionals and budget holders want and value. We are focused on maintaining our position as a leading pan-European specialty pharmaceutical company. Through creative and flexible partnering, we will continue to drive the growth of our product portfolio and foster our pipeline. In addition to our leading products, XIFAXAN® 550, MOVICOL®, MOVIPREP®, Norgine has a strong portfolio of development projects, principally in the areas of gastroenterology, hepatology and supportive care.

For more information - www.norgine.com



Ocera Therapeutics, Inc. is a clinical stage biopharmaceutical company focused on the development and commercialization of OCR-002 (ornithine phenylacetate). OCR-002 is an ammonia scavenger which has been granted Orphan Disease and Fast Track status from the FDA to treat hyperammonemia and associated hepatic encephalopathy in patients with liver cirrhosis, acute liver failure and acute liver injury.

For information, please see www.ocerainc.com



Salix Pharmaceuticals is a specialty pharmaceutical company that offers innovative gastroenterology treatments.

We are committed to licensing, developing, and marketing products to treat gastroenterology disorders. It is our mission to give healthcare professionals and patients the most effective solutions in gastroenterology.

For more information - www.salix.com



Science has been at the heart of Yakult since its probiotic drink was developed in 1935. The company sponsors independent researchers in hospitals, universities and institutes throughout the world. Over 100 human studies on Lactobacillus casei Shirota have now been published in peer-reviewed papers.

For more information at www.yakult.co.uk/hcp or contact science@yakult.co.uk for free educational resources.

SPEAKERS



Agustín Albillos

Agustín Albillos is Head of the Department of Gastroenterology and Hepatology at Hospital Universitario Ramón y Cajal, and Professor of Medicine at the University of Alcalá, Madrid, Spain. He has been working in the field of cirrhosis and its complications, since his postdoctoral fellowship at Prof. Bosch and Prof. Groszmann's laboratories. He is President Elect of the Spanish Association for the Study of the Liver, and member of EASL and AASLD.



Jan Albrecht

Education: 1966 – M Sc. (Biology) University of Warsaw; 1970 – Ph. D. (Biochemistry) University of Leiden. Position: Professor and Head, Department of Neurotoxicology, Mossakowski Medical Research Centre, Polish Academy of Sciences, Warsaw, Poland. Memberships: European Academy, Polish Academy of Sciences, Editorial Boards, among others: Journal of Neurochemistry. Neurochemical Research (Associate Editor).



Piero Amodio

Piero Amodio was born on June the 11th 1953 in Udine, Italy. He lives in Padova. E.mail address: piero.amodio@unipd.it

Education

1978 qualification (110/110 cum laude) in Medicine at the University of Padova with the thesis "Study on the renal proximal tubular function in liver cirrhosis by means of urinary enzymes measuring".

1982 Specialised in Respiratory Medicine (70/70 cum laude) with the thesis "Lung metabolism of PGE2 and PGF2α in liver cirrhosis". 1987 Specialised in Internal Medicine in (70/70 cum laude) with the thesis "Carnitine metabolism in liver cirrhosis".

1993: 6th European Educational Programme in Epidemiology, Florence.

1997: Grant CNR/FNRS) for research at the "Unité d'Explorations Electrophysiologiques du Système Nerveux" of the Catholic University of Bruxelles.

1998 and 1999 Attendance of the 12th and 13th Course of Clinical Electroencephalography. Dpt. of Clinical Neurophysiology. University of Milan.

Professional Activity

From 1978 to 1988 Medical Doctor in the Dpt of Clinical Medicine of the University of Padova.

From 1988 Researcher in the Dpt of Clinical Medicine of the University of Padova.

Responsible of the Service for Cognitive Dysfunctions in Internal Medicine Disorders, Clinica Medica 5, Padova From 2007 Ag. Professor of Internal Medicine

2010 Director of the Interdepartmental Research Centre for Neuropsychiatric Disorders in Internal Medicine (CIRMANMEC), University of Padua

Member of:

- > the Italian Society of Internal Medicine, Secretary of its Veneto Section
- > the Italian Society of Clinical Neurophysiology,
- > the Italian Association of the Study of the Liver. Head of the National Commission for the Study of Hepatic Encephalopathy of the Italian Association for the Study of the Liver.
- > The European Association for the Study of the Liver
- > The Governing Board of the Italian College of Internal Medicine
- > The International Society for Hepatic Encephalopathy and Nitrogen Metabolism (President 2006-2008, Treasurer 2008-2012)

Teaching

1991-2000: Clinical Epidemiology. University of Padua

1996-2001: Clinical Pathophysiology. University of Padua

1996-2011: Dietetics. University of Padua

2000-2012: Internal Medicine University of Padua

Research

The research has dealt with various branches of internal medicine: nephrology, hepatology, and neurological complications of liver diseases.

Nephrology. Methodological aspects of the measurement of urinary enzymes and morpho-functional characterisation of renal damage in jaundice, cadmium intoxication, liver cirrhosis, hypertension and gestosis.

Hepatology. Portal hypertension, its pharmacological treatment and its complications. Prognosis, metabolism and nutrition in liver cirrhosis.

Metabolic encephalopathies. Description and characterisation of the cognitive alterations in liver cirrhosis. Implementation of new computerized tests. Evaluation of confounding factors in neuropsychological testing. Study of the effect of aging on cognitive evoked potentials. Methodological and clinical application of EEG monitoring in hepatic encephalopathy and metabolic encephalopathies. Relationship between the neuropsychological and the neurophysiological finding in hepatic encephalopathy. Study of cognitive potentials in hepatic encephalopathy.

He organized and directs a laboratory on the neuropsychiatric and neurophysiologic alterations in Internal Medicine. Scientific indexes for Dr. Amodio Sum of the Times Cited= 1755, Sum of Times Cited without self-citations=1518, Citing Articles=1277, Citing Articles without self-citations=1221, Average Citations per Item=14.27, h-index=27



Dr. Javier Ampuero

Dr. Javier Ampuero earned his Medical degree in Córdoba (Spain) in 2009. Later, he did his residence in Gastroenterology (2010-2014). During 2013, he was in the Hospital of the University of Pennsylvania (Philadelphia, United States) for three months. Currently, he works at Unit for the Clinical Management of Digestive Diseases in Valme University Hospital (Sevilla, Spain). His primary project has focused on Hepatic Encephalopathy under the mentorship of Dr. Manuel Romero-Gómez. In particular, they are focusing on the role of metformin on spectrum of Hepatic Encephalopathy, as they demonstrated the protective role of this drug. They are carrying out a randomized clinical trial to demonstrate the impact of metformin on cirrhotic patients. In fact, this topic is going to be the focus of his doctoral thesis (in September 2014). On the other hand, they are researching about the role of genetic factors on the methods to detect Minimal Hepatic Encephalopathy. In addition, he has completed a Master of Statistics in Science Research Methodology, what has given him the opportunity to be able to design different studies and perform a variety of statistical analysis. These other researches include topics about Hepatitis C, Hepatocellular Carcinoma, Non-Alcoholic-Fatty Liver Disease, and Inflammatory Bowel Disease.



Djillali Annane

Djillali Annane was appointed Professor of Medicine: Critical Care Medicine at the University of Paris in 1996 having completed his PhD in Pharmacology in 1995 and MD in 1991. Professor Annane also has Specialist Qualifications in Intensive Care Medicine, Cardiology, Internal Medicine, Statistics and Pharmacology. Professor Annane is the Director of the 36-bed intensive care unit at Raymond Poincaré, Assistance Publique Hôpitaux de Paris (APHP) which is the premiere tertiary care hospital in France. He is Chief Counsellor

of the Minister of Health for medical education and research, Dean of the School of Medicine at University of Versailles Saint Quentin and was President of the French Society of Intensive Care (SRLF) from 2011 to 2013. Professor Annane's main research interests are the pathophysiology and management of septic shock and he has been involved as the coordinator / principal investigator of several large multi-national randomized controlled trials. He has published more than 300 peer-reviewed articles.



Vicente Arroyo, M.D.

Professor of Medicine, University of Barcelona Medical School. Consultant of Hepatology, Liver Unit, Hospital Clinic, Barcelona. Director of the Esther Koplowitz Biomedical Research Center. Chairman of the EASL Chronic Liver Failure Consortium. Main research interest: acute on chronic liver failure, ascites and acute bacterial infection in cirrhosis. Member of the Spanish, European, American and International Associations for the Study of the Liver.



Prof Michael Arthur

Professor Michael Arthur is President and Provost of University College London. Prior to this he was Vice-Chancellor of the University of Leeds, and formerly Professor of Medicine (1992), Head of the School of Medicine (1998-2001) and Dean of the Faculty of Medicine, Health and Life Sciences in Southampton (2003-04). He is a hepatologist with research interests in liver cell biology developed initially at the University of California, San Francisco (1986-1988) and more recently as a Fulbright Distinguished Scholar at Mount Sinai School of Medicine in New York (2002). Professor Arthur became a Fellow of the Academy of Medical Sciences in 1998. Professor Arthur has a significant national and international profile. He was Chair of the Advisory Group for National Specialised Services (NHS) (2010-2013) and is a member of the Council of the Medical Research Council. He is a US/UK Fulbright Commissioner and a former Chair of both the Worldwide Universities Network and the Russell Group of Universities. Professor Arthur took up his current post on 1 September 2013.



Jasmohan S. Bajaj, MBBS, MD, MS, FAGC
Jasmohan S. Bajaj, MBBS, MD, MS, is Associate Professor of Medicine, Division of Gastroenterology, Hepatology, and Nutrition at Virginia Commonwealth University and McGuire VA Medical Center in Richmond, VA. He is a Fellow of the American Gastroenterological Association and American College of Gastroenterology. Dr. Bajaj earned his MBBS from Delhi University at Maulana Azad Medical College. He completed an internship in internal medicine at Delhi University at Maulana Azad Medical College and internal medicine residency at the State University of New York Health Science Center in Brooklyn. He furthered his medical training with a fellowship in gastroenterology and hepatology at the Medical College of Wisconsin Affiliated Hospitals, then went on to earn an MS in epidemiology at the Medical College of Wisconsin in Milwaukee. Active in research, Dr. Bajaj has served as a principal investigator or co-investigator for numerous clinical trials in areas such as hepatic encephalopathy, chronic liver disease and microbiome. Dr Bajaj's research has been funded through the NIH, US Veterans Affairs and American College of Gastroenterology. His work has been published in Gastroenterology, Hepatology, the American Journal

SPEAKERS

of Gastroenterology and Liver Transplantation, among others. Dr Bajaj is an Associate Editor for the American Journal of Gastroenterology and Journal of Clinical and Experimental Hepatology and is on the editorial board for Alimentary Pharmacology and Therapeutics and Liver International. Dr. Bajaj frequently presents his work on hepatic encephalopathy and chronic liver disease nationally and internationally at meetings, grand rounds, and symposia and is a member of the Hepatic Encephalopathy Guidelines Writing Committee. He is also a member of several medical associations, including the American Gastroenterological Association, the American Association for the Study of Liver Disease, and the American College of Gastroenterology. Dr Bajaj is the Chairperson of the Acute-on-Chronic Liver failure Special Interest Group at the American Association for the Study of Liver Disease and for the North American Consortium for Study of End-stage Liver Disease.



Dr William Bernal

Dr William Bernal is currently Consultant and Reader in Liver Intensive Care Medicine in the Liver Intensive Therapy Unit at the Institute of Liver Studies at Kings College Hospital in London UK.

He trained in General Medicine at the Royal London and St Bartholomew's Hospitals in London and in Hepatology and Intensive Care Medicine at St Thomas and Kings College Hospital. He first worked on Liver Intensive Therapy Unit at Kings in 1995 and was appointed as a Consultant in 2002. Annually, more than 1200 patients with liver disease are admitted to this specialist critical care unit which also supports one of Europe's largest liver transplantation programs. The unit has a special interest in acute liver failure and has for many years led in the development and application of innovative therapies for this condition. Dr Bernal's research interests include the pathogenesis of encephalopathy and multiple organ failure in acute and acute-on-chronic liver failure and the use and outcome of liver transplantation. He has published widely in this field and his current research projects include the application of novel techniques to prognostic assessment and the impact of body composition changes on survival in patients with liver disease.



Prof Roger Butterworth

PhD (University of London, UK) in 1969, DSc (University of London, UK) in 1996. Until retirement in 2013, Dr Butterworth held the following appointments: Full Professor, Dept of Medicine, University of Montreal, Adjunct Professor, Division of Experimental Medicine, McGill University and Director, Neuroscience Research Unit, St-Luc Hospital (CHUM), President, International Society of Neurochemistry (2006), President, International Society for Hepatic Encephalopathy and Nitrogen Metabolism (ISHEN) (2009), Editor-in-Chief, Metabolic Brain Disease (1994-1998) Editor-in-Chief, Neurochemistry International (1998-2010), Member, Editorial Board, Hepatology, Journal of Hepatology, Gold Medalist, Canadian Association for the Study of the Liver (2003), Founding Member, Society of Neuroscientists of Africa (SONA), Order of Senegal for Neuroscience teaching and Research in Africa (1998). 725 publications on basic and clinical research in Metabolic Disorders of the CNS including Wernicke-Korsakoff Syndrome, Urea Cycle Enzymopathies and Hepatic Encephalopathy.



Dr. Arthur Cooper

Dr. Cooper is Professor of Biochemistry and Molecular Biology at New York Medical College and Adjunct Professor of Biochemistry in Neuroscience at the Weill Medical College of Cornell University. His research interests include pyridoxal 5'-phosphate-enzymes, enzyme mechanisms, bioactivation mechanisms, neurochemistry, neurodegenerative diseases, chemoprevention, and 1-C, nitrogen, sulfur and selenium biochemistry.



Srinivasan Dasarathy

My talk will be on Skeletal muscle and ammonia disposal: more than just metabolism.

Staff transplant hepatologist at the Cleveland Clinic with specific interest in mechanisms of skeletal muscle loss in liver disease. Our laboratory focuses specifically on transcriptional signaling pathways that regulate skeletal muscle protein synthesis and autophagy during hyperammonemia of cirrhosis using metabolic tracer studies and molecular pathway analyses.



Dr Nathan Davies

Nathan Davies is a Senior Lecturer at the Institute for Liver and Digestive Health in University College London's Division of Medicine. His academic interests relate to the processes related to inflammation and their effects on the body's systems during liver disease processes. Current projects include testing whether modulating gut bacteria reduces systemic inflammation in liver patients has a measurable health benefit.



Nicolaas E Deutz, MD, PhD

Title of Presentation

Targeted fluxomics in humans to measure the synthesis and breakdown of biological molecules.

Nicolaas E Deutz, MD, PhD is active in the field of Clinical Nutrition and Metabolism, presently improving skeletal muscle. At Texas A&M University, he is a tenured and endowed Professor and director and founder of the 6,000 sqft Center for Translational Research in Aging and Longevity Center (CTRL; <http://ctrl.org>).



Radha Krishan Dhiman, MD, DM, FACG, FAMS

Professor, Department of Hepatology, Postgraduate Institute of Medical Education and Research, Chandigarh (PGIMER), India

OFFICE BEARER

1. Editor-in-Chief, Journal of Clinical & Experimental Hepatology (JCEH) (<http://www.jcehepatology.com/>), An official Journal of Indian National Association for Study of Liver (INASL).
2. President Elect, International Society on Hepatic Encephalopathy and Nitrogen Metabolism (ISHEN) for the period 2012-2014
3. Governor of American college Gastroenterology (ACG) for India

MAJOR HONORS

1. Dr BC Roy National Award; This is highest award in the field of Medicine in India; Received from Honorable President of India Smt Pratibha Devisingh Patil on July 2, 2008.
2. President Elect, International Society on Hepatic Encephalopathy and Nitrogen Metabolism (ISHEN), 2012-2014.
3. Harold O Conn award by American Association for the study of Liver (AASLD) at the Annual meeting held in November, Boston, USA
4. "Basanti Devi Amir Chand Award" in 2009, "Amrut Modi Unichem Award" in 2007, "Shakuntala Amir Chand Award" in 1998 and "Dr DV Datta Memorial Oration Award" in 1996 by Indian Council of Medical Research (ICMR) for outstanding contribution in Hepatology.

RESEARCH INTEREST: Hepatic encephalopathy and portal hypertension.



Vicente Felipo

Vicente Felipo obtained his Ph.D degree in Biochemistry from the University of Valencia in 1983. In 1990 he created the Laboratory of Neurobiology of Centro de Investigacion Principe Felipe, Valencia, Spain. He is Director of the Laboratory and of the Program on Neurologic Impairment of the Center.



Prof Alastair Forbes

Alastair Forbes is Professor of Medicine in the Norwich Medical School (UEA). He was previously at UCL/UCLH and St. Mark's Hospital in London. He has been Education Director for the European Society for Clinical Nutrition (ESPEN), Secretary of the British Society of Gastroenterology, and Chairman of the British Association for Parenteral and Enteral Nutrition. His interests lie mainly in intestinal failure and IBD. His CV has over 220 original papers, with an h score of 49, together with many review articles and contributions to guidelines.



Dr Daniel Forton

Dr Daniel Forton BSc, PhD, MBBS, FRCP is a Consultant Hepatologist and Reader at St. George's University of London, UK.

He qualified at University College London and trained in Gastroenterology, Hepatology and General Medicine at St Mary's, Charing Cross and Hammersmith Hospitals, London.

During his training he was appointed as a Research Fellow and subsequently, as a Clinical Lecturer at Imperial College London, performing basic scientific and clinical research into the CNS manifestations of chronic hepatitis C infection. He was awarded a PhD from Imperial College London in 2004 and the Dame Sheila Sherlock Research Medal from the British Association for the Study of the Liver. Dr Forton's work includes the first evidence of a biological effect of HCV on brain function using magnetic resonance spectroscopy and definition of the neuropsychological impairments seen in this infection.

His current research interests include ongoing studies into HCV related cognitive effects and predictors of interferon induced depression/cognitive dysfunction, with over 20 original publications and book chapters in this area. He is Associate Medical Director for Research at St George's and runs a busy clinical hepatology and trials service, with a key interest in novel antiviral therapies for HCV.

SPEAKERS



Dr Rita Garcia-Martinez

Dr Rita Garcia-Martinez earned her medical speciality in Internal Medicine-Hepatology in Vall d'Hebron. During her predoctoral training she focuses on hepatic encephalopathy and the long-term consequences after successful liver transplant under the supervision of Prof Juan Cordoba. After her postdoctoral fellowship in UCL-London conducting a translational program in liver failure she is back in Spain working in liver failure and its complications.



Dr. Oec. Troph. Boris Görg

Boris Görg studied nutritional sciences and graduated with diploma at the University of Bonn in Germany. He completed his doctorate dealing with molecular mechanisms involved in the pathophysiology of hepatic encephalopathy at the Department of Gastroenterology, Hepatology and Infectiology of the University Clinic of Düsseldorf where he is currently working as a scientific research associate. His scientific research focuses on the role of osmotic and oxidative/nitrosative stress in the pathophysiology of hepatic encephalopathy.



Tarek Hassanein MD, FACP, FACC, AGAF

Dr. Tarek Hassanein is board certified in Gastroenterology and Hepatology and is a Professor of Medicine at the UCSD School of Medicine. A leading expert in liver diseases, Dr. Hassanein is renowned for management of viral hepatitis, fatty liver, cirrhosis, liver cancer, and pre/post liver transplant care. Prior to joining SCLC, Dr. Hassanein was the Director of the UCSD Liver Center and Medical Director of Liver Transplantation from 1997 to 2009. Dr. Hassanein earned his medical degree from Alexandria University in Egypt, and completed Residency in Internal Medicine at Wayne State University in Detroit, Michigan. He completed a Research and Clinical Fellowship in Gastroenterology, Hepatology, and Transplantation at the University of Pittsburgh in 1994.



Professor Dr. Dieter Häussinger

born 22.06.1951 in Nördlingen/Bavaria
Full Professor of Internal Medicine and Director of the Clinic for Gastroenterology, Hepatology and Infectious Diseases at the Heinrich-Heine-University Düsseldorf. Director of the Center of Liver and Infectious Disease and of the W. Hirsch Institute for Tropical Medicine at Adama University (Ethiopia). Dean of the Medical Faculty (1998-2002). Member of the German Science Council (Medicine Committee) (2000-2007). Senator Scientific Community Leibniz (since 2010). Head of the Collaborative Research Center SFB 575 „Experimental Hepatology“ (2000-2011) and the Collaborative Research Center SFB 974 „Communication and Systems Relevance of Liver Damage and Regeneration“ (since 2012); Spokesman of the Clinical Research Group KFO 217 „Hepatobiliary Transport and Liver Disease“ (since 2010). Many honours and awards; among these Thannhauser Prize (1989), Gottfried-Wilhelm Leibniz-Prize (1990), Honorary Prize of German Order of Druids (1995), Dr. Robert-Pfleger Prize (2002) and the Order of Merit of the German Federal Republic (2011). Member of the Academy of Science Leopoldina and the Northrhine-Westfalian Academy of Science and Arts.



Professor Elaine Holmes

Professor Holmes (PhD) is a Professor of Chemical Biology at Imperial College London and Head of Division of Computational and Systems Medicine. Her main research area focuses on applying metabolic profiling and computational modelling of biofluids and tissues to understand pathological and physiological processes. She has a broad background in metabolic chemistry, with specific expertise in spectroscopy and in chemometric modeling of spectral data. She began her research career investigating molecular mechanisms of toxicology using spectroscopic methods and then broadened the scope to research clinical pathologies in a range of clinical fields. Prof Holmes has several research projects investigating the consequences of modification of the gut microbiota and has particular interest in the gut-brain axis. Her research involves both the development and application of spectroscopic and chemometric methods, and in particular the fusion of metagenomic and metabonomic data to provide a readout of the functionality of the microbiome. She has also been involved in development of methods for improving the extraction of latent biomarker information from spectral data. She holds visiting Professorships with a number of universities including CEU Madrid and the Chinese Academy of Sciences in Wuhan.



Susanne Keiding MD, DSc

Associate Professor
Department of Hepatology and Gastroenterology
Department of Nuclear Medicine & PET Centre
Aarhus University Hospital and Aarhus University
DK-8000 Aarhus C
Denmark

Adjunct Professor
Department of Neuroscience and Pharmacology
University of Copenhagen
DK-2100 Copenhagen
Denmark

Specialist in medicine, hepatology and gastroenterology.
Scientific training in physiology, mathematics, experimental and clinical hepatology.

Present scientific interests: Hepatic blood circulation, metabolic function, bile acid excretion, removal kinetics; hepatic encephalopathy.
Studies in humans and pigs using PET/CT of the liver, brain and muscles – and hepatic vein catheterization.



Gerald Kircheis

Date of Birth: 13.09.1957 in Teutschenthal, Germany
Degrees, Diplomas, past and present positions
Study, Education
1976-1982

Study of Medicine at Martin-Luther-University Halle-Wittenberg, Diploma of the Medical School and Creditation of Approbation as physician at Martin-Luther-University Halle-Wittenberg
1981-1985 Dissertation at Biochemical Institute (Medical Faculty) of Martin-Luther-University Halle-Wittenberg

Postgraduate specialisation in General Internal Medicine and full accreditation as "Specialist in General Internal Medicine" at Martin-Luther-University Halle-Wittenberg
1981-1987

Postgraduate specialisation in

Gastroenterology and Hepatology at the Department of Hepatology / Gastroenterology and Endoscopy at Martin-Luther-University Halle-Wittenberg

1991-1998 Senior Clinical Research Physician and Head of the Department of Clinical Research (Hepatology/Gastroenterology / Metabolism Research Unit) at Merz+Co. GmbH, Frankfurt, Germany

1998-2009 Specialist of Internal Medicine in the Department of Gastroenterology, Hepatology and Infectious Diseases at Heinrich-Heine-University Düsseldorf

2001-2012 Partial Project Leader C4 in SFB 575 „Experimental Hepatology“

Since 2010 Consultant, Department of Gastroenterology, Hepatology, and Infectious Diseases at Heinrich-Heine-University Düsseldorf (Direktor: Prof. Dr. D. Häussinger)



Professor Rajiv Jalan

Professor Rajiv Jalan is Professor of Hepatology at the UCL Medical School. He has a strong clinical academic interest in translational research in the area of liver failure. He has been closely involved in the discovery of ornithine phenylacetate; a new treatment for hepatic encephalopathy. His work provided the seminal observation of the role of hypothermia in patients with uncontrolled intracranial hypertension, an intervention that has become routine in many units around the world. His research has focused on acute-on-chronic liver failure (ACLF), a syndrome which he identified as a new clinical entity.

He is currently the President of ISHEN and Editor-in-Chief of the Journal of Hepatology.



Radhakrishnan Jayakumar

Dr Jayakumar is a Research Associate Professor of Neuroscience at the Miami VA Hospital. He is currently examining the role of astrocytes in acute/chronic hepatic encephalopathy. His research interests include the role of blood-brain barrier in the development of cytotoxic brain edema, mechanisms of BBB integrity, and cell-cell interaction in HE.



Wim Laleman, MD

Dr. Laleman earned his M.D. from Catholic University of Leuven in 2000 where he completed his internal medicine residency, gastroenterology-hepatology fellowship and advanced training in endoscopic retrograde cholangiopancreatography (ERCP) and endoscopic ultrasound (EUS). In 2006, he obtained his Ph.D. on "The role of hepatic stellate cells and vascular mediators in the pathophysiology of cirrhotic portal hypertension".

Since 2008, he has been a member of the faculty of the Department of Liver and Biliopancreatic disorders at the Leuven University Hospitals.

In addition to continuous clinical and teaching assignments, he has a strong research interest, both clinically and basically, on complications of cirrhosis focusing on portal hypertension (variceal hemorrhage, ascites, ...) and liver insufficiency (hepatic encephalopathy, bacterial translocation, ...) leading to numerous publications. In this capacity, he was granted a Senior Clinical Investigatorship by the Research Foundation-Flanders since 2010 and was awarded the Prize George Brohé in 2009.

SPEAKERS

Dr. Laleman is currently Secretary of the Belgian Association for the Study of the Liver (BASL). He is member of European Association for the Study of the Liver (EASL) and the European Society of Gastrointestinal Endoscopy (ESGE) and serves as manuscript reviewer for several medical journals, including, amongst others, Endoscopy, the Journal of Hepatology, Hepatology, the European Journal of Gastroenterology and Hepatology and Liver International.



Andrew Langford

Chief Executive, British Liver Trust

Andrew Langford joined the British Liver Trust in August 2011. With a wealth of experience, Andrew has worked in Chief Executive and trustee roles for an umbrella dermatology charity, voluntary sector hospices and HIV, cancer and children's charities.

Andrew has a distinguished reputation in the charity sector, being chosen to Chair the Parliamentary Inquiry into Skin Cancer and also developed an internationally recognised centre of excellence in the hospice care of people with HIV related encephalopathy.

Andrew's most recent role as the Chief Executive of the Skin Care Campaign gave him the opportunity to raise the profile of skin conditions in the UK, ensuring the Campaign was a fundamental player in the dermatology health community and policy areas.

With over 30 published papers with the BMJ, HSJ and other professional journals, Andrew has embraced his role in improving care in various health sectors, such as dermatology, HIV, palliative care and dementia.

Early on in his career, Andrew trained as a registered general nurse before returning to academia to undertake a degree in History at Oxford University and then continued his education with a Masters degree in Political History at Huddersfield University.

Andrew is married with one daughter, Lillie, and is a reluctantly retired rugby player, although still a keen fan.



Fin Stolze Larsen

Consultant at Dept. Hepatology, Rigshospitalet, University Hospital of Copenhagen. Responsible for the liver ICU, and Lab., research activities. Doctor of Medical Science (DMSc) and Ph.D. Author of a number of scientific papers, mainly with emphasis on metabolic encephalopathy, cerebral oedema, systemic haemodynamics, liver support devices and liver regeneration. Principle Advisor for several PhD- and DMSc- thesis ((DMSc.) from the Dept. Hepatology as well as member/chair of the evaluation committee of numerous Ph.D. theses. Steering member of the acute liver failure group, the CLIF consortia and reviewer for several international journals, universities, scientific organizations and foreign governmental research institutions.



Dr Alistair Lee

Dr Alistair Lee has been a consultant in Critical Care and Transplant Anaesthesia in Edinburgh, UK since 1991 with a particular interest in acute liver failure.

The Edinburgh group produced some of the earliest studies on the use of induced hypothermia in the management of raised intracranial pressure in acute liver failure in the late 1990s. Additional studies examined cerebral autoregulation in this condition, the effects of liver reperfusion on cerebral haemodynamics, and the use of hypothermia during orthotopic liver transplantation.

Dr. Lee has contributed to the development of a porcine

model of acute liver failure secondary to paracetamol poisoning, and has experience in the use of albumin dialysis and bioartificial extracorporeal liver support systems in acute liver failure.

He has conducted earlier studies on systemic haemodynamic changes in liver transplant recipients using different methods of reperfusion, and acute liver failure patients receiving N-acetylcysteine.

Dr. Lee has examined the use of near infrared spectroscopy as a non-invasive method to measure intracranial pressure, and more recently the use of optic nerve sheath ultrasound measurements as a surrogate marker of intracranial pressure.

He is currently Secretary / Treasurer of LICAGE (Liver Intensive Care Group of Europe) and has spoken extensively on a range of topics associated with acute liver failure and liver transplant anaesthesia.



Julian Marchesi

Julian Marchesi graduated from Cardiff University with a PhD in biochemistry (1992) and became interested in the role bacteria play in ecosystem function. His work uses a variety of "omic" approaches such as metagenomics, metatranscriptomics, metabonomics and molecular ecology to investigate the human microbiome. Over his 22 year career he has authored over 75 peer-reviewed publications and is an editor/senior editor for ISME Journal, FEMS Microbiology Ecology and BMC genomics and is a current member of the editorial boards of Journal of Medical Microbiology and Microbiome and past member of the Journal Microbiology Methods, Current Issues in Molecular Biology, and Molecular Biology Today.



Prof Manuela Merli

Professor Merli is a consultant hepatologist and gastroenterologist at the Department of Gastroenterology II Polyclinic Umberto I, University La Sapienza of Rome. She currently teaches internal medicine and gastroenterology in the schools of medicine and nursing. Prof. Merli graduated in medicine in 1980 and is an author of over 240 scientific publications. Her research activities include, among other things, chronic hepatitis, liver cirrhosis, and liver transplantation. Prof Merli has particular expertise in nutrition in the context of liver disease and has published extensively in this area.



Dr Sara Montagnese (MD, PhD)

Dr Sara Montagnese (MD, PhD) is a Reader in Medicine and Honorary Consultant Physician at the University of Padova, Italy. Her research interests lay in metabolic encephalopathies, particularly hepatic encephalopathy, sleep and circadian rhythms, on which she has published extensively.



Dr Rajeshwar Mookerjee

Dr Mookerjee is a UCL senior Lecturer and a consultant in hepatology at the Royal Free Hospital, London. His clinical and research interests focus on the complications of chronic liver disease including vascular dysfunction in cirrhosis and its intervention, and the evolution of acute-on-chronic liver failure. Integral to this process is the understanding of the role of infection and inflammation

in provoking organ injury. This is on-going research, coupled with the development of early prognostic markers to predict outcome in liver failure. Studies of relevant biomarkers are also being used to help inform the design of new interventions in liver disease. The focus of the translational research program is exploring hypotheses in models of liver disease to elucidate the pathophysiological derangements observed in patients.



Marsha Y Morgan

Qualified in medicine with distinction and undertook her early clinical training in Manchester and London. Undertook specialist training in Gastroenterology in London and then joined Professor Dame Sheila Sherlock in the Department of Medicine at the Royal Free Hospital School of Medicine, initially as a Research Fellow but subsequently as Lecturer and then Senior Lecturer in Hepatology within the same Department. Following the merger with University College London, she was promoted to Reader in Medicine and subsequently to the position of Principal Research Fellow.

Her main research interest is in alcohol misuse and alcohol-related liver disease but she also has considerable research interests in hepatic encephalopathy and nutrition in liver disease.

Her interest in alcohol misuse and alcohol-related liver disease has resulted in appointments to the World Health Organisation Expert Committee on Drug Dependence and Alcohol Problems; the Ministry of Transport Medical Advisory Panel on Alcohol, Drugs and Substance Misuse and Driving and the Royal College of Physicians and the Royal College of Psychiatrists Working Parties on Alcohol and the Institute for Alcohol Studies. In the last three years she has been involved in the development of five major NICE documents. She is currently actively engaged in research into the genetics of alcohol-related cirrhosis

Her interests in hepatic encephalopathy have resulted in her appointment to the Executive Board of the International Society for Hepatic Encephalopathy and Nitrogen Metabolism (ISHEN). Her current research interests are in the utility of neurophysiological variables for the diagnosis of hepatic encephalopathy and the efficacy of various treatment options.

Her interest in nutritional aspects resulted in her playing a major role in the development of the ISHEN guidelines for the nutritional management of hepatic encephalopathy. She has recently validated two new methods for assessing nutritional status in patients with cirrhosis which are likely to become the gold standards for use in this population. Her current research interest is in the management of malnutrition in patients with chronic liver disease.



Prof Kevin Mullen

Professor Kevin Mullen graduated from medical school in Dublin (UCD) and trained in McMaster University in Internal Medicine. His Gastroenterology and Hepatology training were obtained in Case Western Reserve University and the National Institutes of Health respectively. He has been on staff in Metrohealth Medical center since 1986 and Became Professor of Medicine in 1999.

SPEAKERS

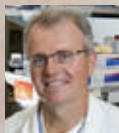

Scott L. Nyberg, M.D., Ph.D.
Professor of Surgery

The overall goal of my research program is to develop cell-based therapies for the treatment of patients with liver failure and metabolic liver disease. I am uniquely trained as a liver transplant surgeon and a biomedical engineer. I also serve as the Director of Liver Regenerative Medicine for the Mayo Clinic. My laboratory has extensive expertise in the isolation and cultivation of primary hepatocytes for use in cellular therapies. We have designed and tested several bioartificial liver devices including our current device - the Spheroid Reservoir Bioartificial Liver (SRBAL)- which will be the focus of my talk.



Dr. Jude A. Oben BM, BCh(Oxon), PhD, FRCP
(Lond & Edin)

After medicine at Oxford (St John's College), with a stint at Stanford as a research fellow in Immunology, a foray into ophthalmology was followed by critical care at St Thomas' Hospital and a decision on Hepatology as a career path. Post-doctoral fellowship was at Johns Hopkins University, mentored by Professor Anna Mae Diehl leading to a Wellcome Intermediate Fellowship. Dr. Oben's productive research Group focuses on mechanisms of non-alcoholic fatty liver disease and autonomic nervous system regulation of liver repair.



Marc Oria PhD

I finished my degree in Biology at the University of Barcelona (Spain) in February 2003, and followed this with PhD studies in the group of metabolic encephalopathies, led by Professor Joan Cordoba, which was awarded in March 2011. My research interests during the PhD were focused on the study of the neuronal function in different liver failure animal models. During this research, I developed a new model to assess hepatic encephalopathy using neurophysiology methods where induction and recording of the motor evoked potentials without anaesthesia in free moving rats was assessed. This method has been validated as a new model to investigate Hepatic Encephalopathy without the confounding effects of anaesthesia. During this period, I also obtained a DEA in Neuroscience (specialized post-graduate research course in Biomedicine, mandatory to obtain a PhD) from the University Autònoma de Barcelona.

From September 2003 to January 2004 I had the opportunity to work in close collaboration with the Gastroenterology Group of the Germans Trias y Pujol Hospital (Badalona, Spain), under the supervision of Dr. Ramón Bartolí and Dr. Josep Mafè. During this period I gained expertise in the induction of cirrhosis in animal models and worked with IL-10 knock-out mice in models of inflammatory intestinal diseases.

In February 2004, I worked in the neuroscience laboratory in Hospital Saint-Luc (Montreal, Canada), led by Dr. Roger Butterworth, where he learned the portacaval anastomosis surgical technique in rats for the development of hepatic encephalopathy in animal models.

In 2008 I did collaboration with Pr. Miodrag and Dr. Erceg in the Principe Felipe Research Center (Valencia) assessing the function of the motor tract in rats after spinal cord injury.

In July 2010, I visited the Cellular Biology and genetics department in the Alcalà de Henares University (Alcalà de Henares, Spain) with the objective of assessing the process of injury to the motor tract in experimental animals. This visit initiated a series of and collaborations

with Dr. Guillermo Bodega, a neuropathologist who later visited the laboratory of Dr Cordoba in Barcelona.

In September 2012, I was awarded with Damme Sheila Sherlock EASL Post-Doctoral Fellowship to develop a new project in the University College of London (UCL) with Prof. Rajiv Jalan. During this post-doc experience I developed new skills in molecular biology and working in the senescence pathways activated in the brain from liver disease animal models.

In June 2012, I established a new Collaboration with Dr. Erceg and Dr. Moreno in the Principe Felipe Research Center (Valencia) assessing the function of the motor tract in rats after spinal cord injury.

During this process I established relationship with several scientists around the world and I published in top journals with high impact factor.

In 2012 I was awarded with the Post-Doctoral EASL Dame Sheila Sherlock Grant to study the Neurodegenerative process present in liver disease and acute-on-chronic liver disease in the Liver Failure group, Royal Free Hospital, UCL (London) led by Professor Rajiv Jalan.

In 2014 I start a new research line in the Translational Research in Fetal Surgery for Congenital Malformations Center for Fetal, Cellular and Molecular Therapy at the Cincinnati Children's Hospital Medical Center (CCHMC) studying the effect on the central nervous system by spina bifida and possible therapies.



Dr. James Orr

Dr. Orr is a Clinical Research Fellow in Hepatology at Newcastle University, interested in chronic liver disease and cirrhosis and its complications, specifically in the development of novel systems of structured care delivery in advanced liver disease. He works with the d-LIVER consortium, an EC FP7 project developing technology for home monitoring of patients with decompensated cirrhosis, including Hepatic Encephalopathy. Within the scope of this work he has developed an interest in the Health Related Quality of Life and Health Economic aspects of advanced liver disease.



Peter Ott, Dr.MSc. MD

Assistant Professor
Head of Medical Department V, Hepatology and Gastroenterology
Aarhus University Hospital, Denmark
Peter Ott graduated from the Medical Faculty in Copenhagen. He received his training in Hepatology at Department A at Copenhagen University Hospital which was then headed by Professor Niels Tygstrup. Peter Ott specialized as a hepatologist in 1996 and served as a consultant at Copenhagen University Hospital until he became Head of Department V at Aarhus University Hospital in 2004. This has a highly specialized hepatological profile in Denmark and a strong research profile under the academic leadership of professor Hendrik Vilstrup, the lab now involving 18 PhD students and a production of around 50 peer reviewed paper a year. Peter Ott has published more than 135 papers including reviews, textbook chapters, and research papers. His longstanding interest in hepatic encephalopathy focus on the consequences of ammonia on the metabolism and clinical course in acute and chronic liver failure.



Oliviero Riggio

Oliviero Riggio, born in Roma on 14/9/1952, married, 3 children, is Associate Professor of Gastroenterology at "Sapienza" University of Rome.

Oliviero Riggio's main research topic is the

complications of liver failure. In this field, by using both clinical methodologies and experimental models, he studied the pathophysiology and treatment of hepatic encephalopathy, the alterations of glucose, lipid and protein metabolism, the alterations in nutritional state and the therapy of portal hypertension. For the above purposes he developed and utilized different laboratory methodologies such as amino acids, GABA, and other neurotransmitters determination in biological fluids and tissues, the metabolic fate of amino acids and other substrates in isolated tissues "in vitro", the euglycemic clamp technique and indirect calorimetry. He developed and used experimental models of liver failure such as the portacaval shunt and the carbon tetrachloride-induced cirrhosis in the rat. He carried out several randomized controlled trials on branched chain amino acids, lactitol and zinc as new tools in the treatment of hepatic encephalopathy, and on TIPS in the prevention and treatment of the complications of portal hypertension.

He published more than 200 papers. His H-Index is 31 (according to Web of Knowledge).



Don C. Rockey, M.D.

Don C. Rockey received his bachelor's degree in biology (summa cum laude) from Virginia Polytechnic Institute and State University, and he earned his M.D. from the Medical College of Virginia. Dr. Rockey completed his internship, residency and fellowships in gastroenterology at the University of California San Francisco. In 1997 Dr. Rockey joined the faculty at Duke University Medical Center as Chief of Hepatology and Director of the DUMC Liver Center in North Carolina. In 2005 he moved to Texas to head the Division of Digestive and Liver Diseases at UTSW. In 2012 Dr. Rockey joined the Medical University of South Carolina as Chairman for the Department of Medicine.



Christopher Rose

Christopher Rose received his PhD (Biomedical Sciences) from the Université de Montréal in 2000 under the supervision of Prof Butterworth. He continued his research interests in Europe by pursuing post-doctoral studies in Germany (Prof. Kettenmann, Berlin), Spain (Prof. Felipo, Valencia and Prof. Cordoba, Barcelona) and Norway (Dr. Ytrebo, Tromsø). In doing so, he was the recipient of 3 prestigious post-doctoral fellowship awards from the Alexander von Humboldt Foundation (Germany), CIHR (Canada) and the European Association for the Study of the Liver (Europe). He is currently Associate professor in the Department of Medicine at the Université de Montréal and his laboratory, Hepato-Neuro, has been established at the CRCHUM since 2006. Dr. Rose has published over 50 articles, many in high-impact journals such as New England Journal of Medicine, Gastroenterology, Hepatology and Journal of Hepatology. His research interests lie within the area of hepatic encephalopathy, a major neuropsychiatric complication of liver disease. As much as 80% of patients with cirrhosis suffer from hepatic encephalopathy, which leads to substantial morbidity and mortality and has a significant impact on neurological outcome following liver transplantation, the only curative approach to this day. Translational research is the primary objective of Dr. Rose's laboratory and, therefore, his research program is based on a bench-to-bedside concept. Throughout his career, Dr. Rose has vested interest in identifying the pathogenic factors and the pathophysiological pathways involved in the development of cerebral complications associated with liver disease. Ultimately, the ability to recognize pathogenic factors and mechanisms of the disease will lead to novel therapeutic approaches, which in turn will improve management of patients with liver disease and enhance neurological outcome following liver transplantation. Dr. Rose's laboratory is currently

SPEAKERS

funded by the Canadian Institutes of Health Research, The Canadian Liver Foundation, and the Fonds de Recherche du Québec en Santé. In addition, Dr. Rose is currently Secretary of the International Society for Hepatic Encephalopathy and Nitrogen Metabolism, and Chair of the Research Committee of the Canadian Association for the Study of the Liver.



Faouzi Saliba

Faouzi SALIBA is an Associate Professor in Gastro-Enterology and Hepatology at the University of Paris IX, France and is in charge of the Intensive Care Unit at the Hepato-Biliary Centre and Liver Transplant Unit at Paul Brousse Hospital (Assistance Publique-Hôpitaux de Paris). He is a consultant in Gastroenterology and Hepatology and has been working for over 25 years in the management of patients affected with hepato-biliary diseases and liver transplantation.

Dr Saliba is a member of the Paul Brousse Clinical Research group on liver transplantation and since the early 1990's, he has conducted, coordinated and participated in several international and national clinical trials in the fields of transplantation, hepatology, artificial liver support, immunology and infectious diseases.

He is a membership of several intra-hospital and national committees, including the Francophone society of transplantation, Gastroenterology, Hepatology, Digestive Endoscopy, Intensive care, Hepato-biliary Surgery and Transplantation societies. Dr Saliba is also a member of the European Society for Organ Transplantation, the European Association of the Study of Liver Disease, the International Liver Transplantation Society and the American Society of Microbiology.

He has published over 130 original papers in official and peer-reviewed journals, and a large number of other journal articles, book chapters and textbooks. Dr Saliba has also presented, during the last twenty years, hundreds of original papers at conferences and has chaired numerous sessions and symposia at national and international congresses.



Professor Freimut Schliess

Professor Freimut Schliess is a biochemist with longstanding contributions in the fields of Experimental Hepatology and Molecular Medicine. He received his scientific training in the laboratory of Prof. Dr. Dieter Häussinger (Heinrich-Heine-University, Düsseldorf, Germany). Major scientific contributions include the discovery of hepatic insulin resistance mechanisms and of key cerebral pathways in Hepatic Encephalopathy. Today he heads the Scientific Affairs department at Profil Institute of Metabolic Research (www.profil.com, Neuss, Germany), a privately owned research institute contributing to early phase clinical development of drugs and medical devices for people with diabetes. Freimut Schliess has awarded the Heinz Kalk prize for scientific achievements in hepatobiliary transport physiology and metabolism. Publications: <http://www.ncbi.nlm.nih.gov/pubmed/?term=Schliess>



Peter Se arson

Peter Se arson is the Reynolds Professor of Engineering and Director of the Institute for Nanobiotechnology at Johns Hopkins University. He received his PhD from the University of Manchester in England and is a fellow of the American Physical Society and the American Association for the Advancement of Science.



Prof Barjesh C Sharma

Prof. Barjesh C Sharma is a professor of gastroenterology at Govind Ballabh Pant Hospital, New Delhi. He has published over 180 papers in the area of gastroenterology and liver diseases and has particular expertise in hepatic encephalopathy and studies evaluating treatments for this condition. Prof Sharma is currently the Secretary General-cum-Treasurer for the Asian Pacific Association for the Study of the Liver (APASL), and also serves as chairman of the Ethics and Guidelines committee.



Debbie Shawcross BSc; MB.BS (distinct); PhD; FRCP

Debbie Shawcross is a Clinician Scientist based at the Institute of Liver Studies, King's College Hospital. She held a HEFCE Clinical Senior Fellowship between January 2008 and 2013 and works as a Consultant Hepatologist on the King's Liver Unit with a specialist interest in hepatic encephalopathy. She is the lead for Education and Training in Hepatology within King's Health Partners, the Academic Health Sciences Centre and is the Training Programme Director for Gastroenterology and Hepatology Specialist Training in South Thames.

The aims of her ongoing research programme are to characterise the molecular mechanisms underlying the predisposition to infection in liver failure focusing specifically on neutrophil dysfunction and hepatic encephalopathy



Michael Sørensen

Michael is an M.D. and currently in training as a hepatologist. He has a Ph.D. and is specialized in functional investigations of the liver and other organs affected by diseases of the liver. His work within the field of hepatic encephalopathy has focused on metabolic changes in vivo.



Dr Mark Swain

Dr. Mark Swain is currently Professor of Medicine and a hepatologist (Liver Specialist) at the University of Calgary, where he is also Head of the Division of Gastroenterology and Hepatology. He graduated from an MD-MSc (Pharmacology) combined program at Queen's University, Kingston in 1985, and then completed his Internal Medicine training at the University of Toronto (1985-88) and his Gastroenterology training at McMaster University in Hamilton (1988-90). He then undertook additional training as a Hepatology Medical Staff Fellow in the Liver Unit at the National Institutes of Health, Bethesda Maryland, USA (1990-93). Dr. Swain is currently a clinician-scientist at the University of Calgary where he is funded by the Canadian Institutes for Health Research for basic laboratory-based bench research in 2 main areas: (i) mechanisms underlying the development of sickness behaviors (ie. symptoms) in the context of liver disease, and (ii) the innate immune response and hepatic inflammation. His clinical research is focused in the areas of viral hepatitis and autoimmune liver disease. Dr. Swain has published numerous peer-reviewed papers and book chapters and has served on the Editorial Boards for a number of scientific journals including Gut, American Journal of Physiology and Clinical Sciences. He has won many awards for teaching and research, including the University of Calgary Watanabe Distinguished Achievement Award for Overall Excellence. He currently holds the Cal Wenzel Family Foundation Chair in Hepatology, and is Head of the Translational Research Core for the Snyder Institute for Chronic Diseases at the University of Calgary.



SPEAKERS



Simon Taylor-Robinson

Professor Simon Taylor-Robinson joined Imperial College London in 1997, becoming Professor of Translational Medicine in 2007. He was the Dean of the Faculty of Medicine at Imperial College from September 2010-September 2013. He is a career hepatologist with clinical appointments as a consultant at Imperial College Healthcare Trust in London (St Mary's and Hammersmith Hospitals).

Over the past 25 years, he has investigated pathogenic mechanisms in chronic liver disease using a combination of imaging techniques, NMR spectroscopy and mass spectroscopy. He has over 210 publications currently.

Professor Taylor-Robinson has strong connections with Africa, having forged research partnerships through European Framework 7 with clinical and research groups in Nigeria, Senegal and Gambia. He has visited many African countries in a research and clinical capacity, including South Sudan, Sudan and Kenya.

In June 1999, he received a MRC Career Establishment grant for liver fibrosis. This generated industrial sponsorship from Pfizer and GSK. He holds grants from MRC (one is joint with Newcastle, Cambridge and Birmingham University on PBC), NIHR and Wellcome Trust.

He is clinically responsible for patients with liver disease at St. Mary's Hospital (Imperial College Healthcare Trust) and is currently Director of the Imperial Clinical Research Facility, which has access to the largest cohort of viral hepatitis patients for study in Europe, in addition to well characterised patients with fatty liver disease and PBC.

He was awarded the Sir Francis Avery Jones Gold Medal by the British Society of Gastroenterology in 1999 and Linacre Lectureship of the Royal College of Physicians of London in September 2000.



Dr. Alexander S. Thrane

Dr. Alexander S. Thrane received his MBChB (Hons.) from the University of Leicester, United Kingdom, in 2008. After completing foundation year training at Haukeland University Hospital in Bergen, Norway, he went on to study astrocyte physiology and pathophysiology as a PhD fellow. His work examined astroglial water and ion regulation in the context of brain disorders like oedema, migraine, hepatic encephalopathy, hyperammonaemia, as well as during general anaesthesia. The research was sponsored by a Fulbright scholarship, and completed partly at the University of Rochester, NY with Prof. Maiken Nedergaard and partly the University of Oslo with Prof. Erlend Nagelhus. Dr. Thrane received his PhD in two-photon imaging and neurophysiology in 2013, and is currently an ophthalmology resident and postdoctoral fellow at Haukeland University Hospital in Bergen, Norway. His more recent research interests include next-generation genetic analyses and optical imaging in hereditary retinal diseases and Müller glial cell pathophysiology.



Javier Vaquero

Javier Vaquero MD, PhD, performed research on hepatic encephalopathy in the laboratories of Dr. AT Blei (Chicago, 2000-2003) and Dr. RF Butterworth (Montreal, 2003-2008), and on liver regeneration in the laboratory of Dr. N Fausto (Seattle, 2008-2011). He currently leads a Hepatology research laboratory at Hospital Gregorio Marañón (Madrid, Spain).



Hendrik Vilstrup MD DSc FRCP FEBGH

Professor of Medicine and Hepatology and Department Chair, Department of Hepatology and Gastroenterology, Aarhus University Hospital Denmark.

ISHEN president 1986-90 and 2012-12. EASL scientific committee 1991-1996. Chairman Danish Society of Gastroenterology and Hepatology 1995-2000. EASL liaison to the Europ. Board of Gastroenterology and Hepatology 2009-. Chairman EASL-AASLD HE clinical guideline writing group 2011-. Scientific interests complications to cirrhosis, particularly HE, metabolism, and inflammation.



Prof Karin Weissenborn

Prof Wessenborn has been based for many years at Hannover Medical School in Germany and is currently is Associate Professor of Neurology. She has major research interests in Metabolic encephalopathies, HCV-encephalopathy and strokes.



Professor Roger Williams, CBE, MD, FRCP, FRCS, FRCPE, FRACP, FMedSci, FRCPI (Hon), FACP (Hon)

Director, Institute of Hepatology, London and Foundation for Liver Research

Roger Williams is Director of the Institute of Hepatology, London and of the Foundation for Liver Research. Before that, he had established over a period of 30 years, the world renowned Institute of Liver Studies at King's College Hospital.

He is a Fellow of the Academy of Medical Sciences and is the recipient of numerous honorary fellowships, medals and prizes including the American Society of Transplantation Senior Achievement Award in 2004, a Hans Popper Lifetime Achievement Award in 2008, the Distinguished Service Award of the International Liver Transplant Society in 2011, and in 2013 the Distinguished Achievement Award of the American Association for the Study of Liver Disease.

His main clinical and research interests are in acute liver failure, liver transplantation, complications of cirrhosis and management of viral hepatitis.



Professor Richard Wise DM, FRCP, FMedSci

Richard Wise is a professor of neurology at Imperial College London. He has researched brain function, using positron emission tomography and functional magnetic resonance imaging, for the past 30 years. He has published papers on normal brain function, and brain function after stroke and in dementing illnesses. His recent interests focus on the disruption of distributed brain systems by brain disease, resulting in changes in the interaction between domain-specific systems (most notably language and declarative memory) and domain-general systems (attention and cognitive control).



Dr Gavin Wright (MBBS, MRCP, PhD)

Consultant Hepatologist Basildon University Hospital
Honorary Consultant (The Royal Free Hospital, London)
Honorary Senior Lecturer (University College London)
Dr Wright completed a PhD (at the Institute of Hepatology, London with Professor Jalan) investigating the role of inflammation and ammonia in Hepatic Encephalopathy. Dr Wright is now a clinical Hepatologist with ongoing research interests in this and other fields of clinical Hepatology.

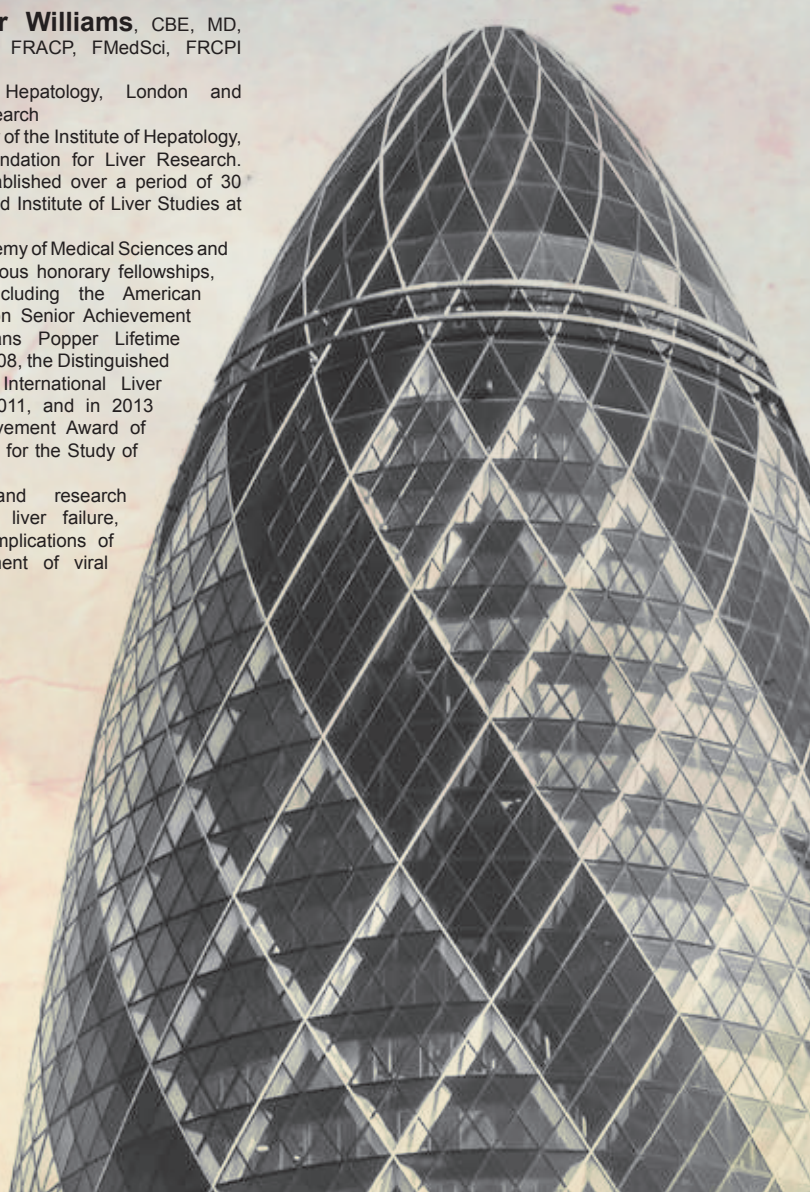

FLOOR PLAN

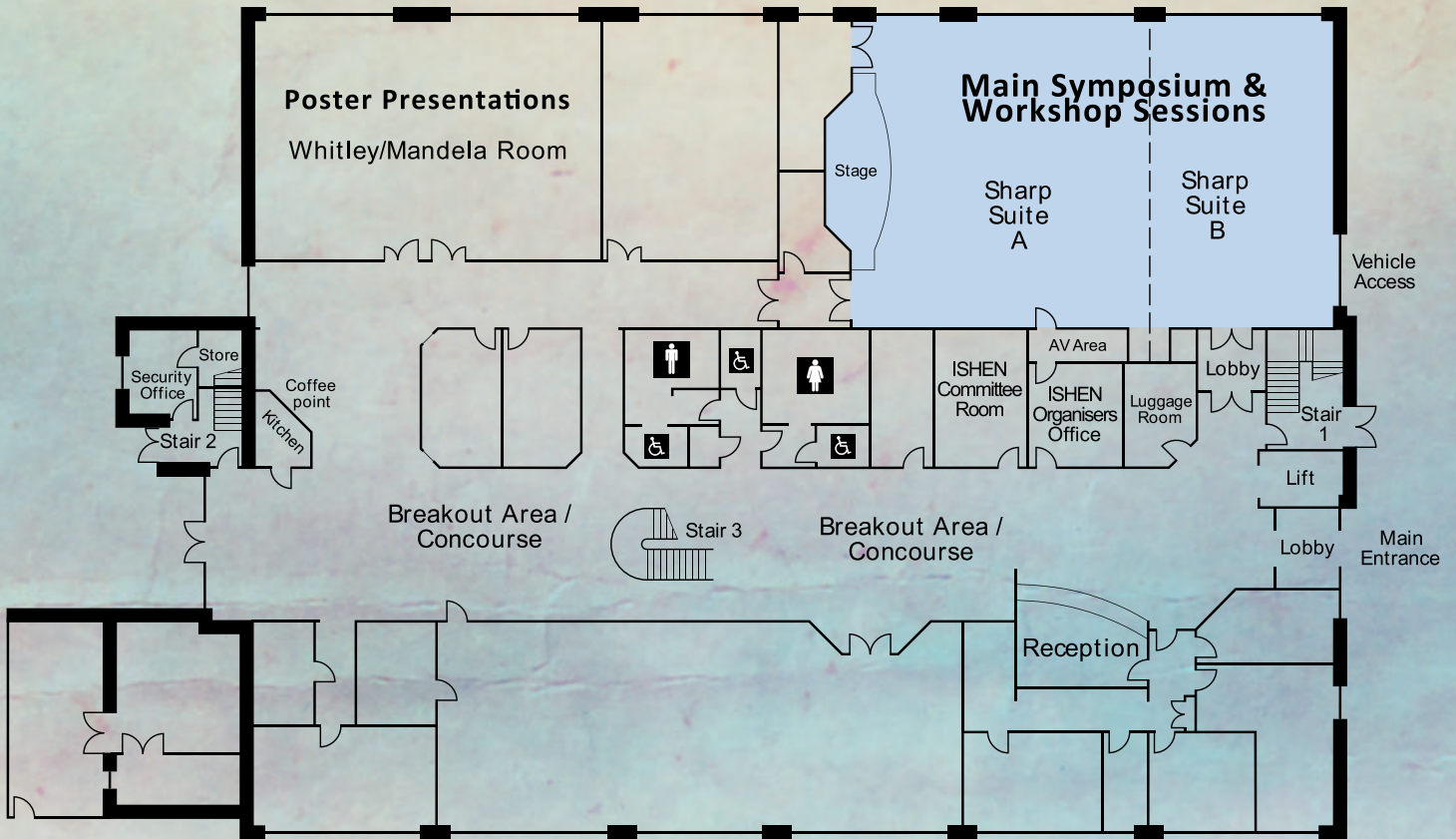

De Vere Venues Sunningdale Park

Sunningdale Park Larch Avenue Ascot Berkshire SL5 0QE UK

ISHEN

Gala Dinner

Northcote House

Medieval Themed Night

12th September 2014

7.30pm

Smart or medieval dress code



INFORMATION

CONFERENCE LOCATION

Sunningdale Park, Larch Ave, Ascot, Berkshire SL5 0QE

REGISTRATION DESK OPENING HOURS:

Wednesday 10th September 2014	10.00 am – 7.35 pm
Thursday 11th September 2014	7.30 am – 6.30 pm
Friday 12th September 2014	8.00 am – 6.30 pm
Saturday 13th September 2014	7.30 am – 11.00 am

EXHIBITION OPENING TIMES:

Wednesday 10th September 2014	12.30 pm - 7.35 pm
Thursday 11th September 2014	8.00 am – 6.30 pm
Friday 12th September 2014	8.00 am – 6.30 pm
Saturday 13th September 2014	7.30 am – 10.45 am

REFRESHMENT BREAKS AND LUNCHES

All lunches will be held at the “Steam Bake and Grill” restaurant just outside the conference centre.

Lunches will be served on each day to all delegates wearing an official ISHEN name badge.

Refreshments will be served in the concourse area in the conference centre.

Where possible, products containing modified soya and maize have been avoided but some products may contain ingredients produced from genetically modified maize. Some of the menu items may contain nuts, seeds and other allergens and there may be a risk that traces of these could be in any other dish or food served at the conference. Please inform the registration desk on arrival of any special dietary requirements.

Water will be available from fridges at all times during the symposium - please help yourself.

OFFICIAL LANGUAGE

The official language of the conference is English.

SOCIAL PROGRAMME

Leaflets detailing local attractions and theatre productions can be found at the Hotel reception desk. If you require information on local restaurants please ask at the Hotel reception desk.

QUERIES

If you have any other queries or issues relating to your attendance at the conference, please contact the onsite Organisers Office +44 (0) 1344 634118. Following the event, all queries should be directed to the ISHEN Administration office.

ISHEN Conference Managers
Executive Business Support Ltd
City Wharf, Davidson Road
Lichfield
Staffordshire
WS14 9DZ
Tel: +44 (0) 845 838 6083
Fax: +44 (0) 1543 442 140
Email: events@execbs.com
Website: www.ishen.moonfruit.com

GENERAL INFORMATION

CLIMATE

The average maximum temperature in Ascot during September is 15°C with a chance of rain.

ELECTRICITY

The electrical current in the United Kingdom is 240 volts with 3 Pin Plugs. Most hotels provide 110 volt outlets for shavers.

INSURANCE

The conference organisers cannot accept liability for personal injuries sustained, or for loss (or damage to) property belonging to conference participants (or their accompanying persons), either during or as a result of the conference.

MOBILE TELEPHONES

Please ensure that all mobile telephones are switched off during all sessions.

SMOKING POLICY

The Organisers wish to stress that this will be a ‘No Smoking’ conference. Smoking in public places Around Ascot, such as restaurants and on public transport, is not permitted.

POSTER VIEWING AND DISCUSSION

Poster viewing will be in the Whitley/Mandela room.

Wednesday 10th September 2014	12.30pm - 5.45pm
Thursday 11th September 2014	8.30 am – 5.45 pm
Friday 12th September 2014	8.30 am – 6.00 pm
Saturday 13th September 2014	8.00am – 10:45am

Oral Presentations will also be made throughout the conference programme.

Please see programme for presenter timings.

CPD

ISHEN 2014 has been approved by the Federation of the Royal Colleges of Physicians of the United Kingdom for 16 category 1 (external) CPD credit(s)

DATES for the DIARY

The current ISHEN president-elect

Dr Radha K. Dhiman

invites all delegates to the

17th ISHEN Symposium

which will take place in India from

16th to 19th September 2016

SAVE THE DATES